



CIRCUIT-BREAKER SIZE S0, FOR MOTOR PROTECTION, CLASS 10, A-REL. 1.4...2A, N-REL. 26A, SCREW TERMINAL, STANDARD SWITCHING CAPACITY

Figure similar

| | |
|-----------------------|----------------------|
| product brand name | SIRIUS |
| Product designation | circuit breaker |
| Design of the product | for motor protection |

General technical data:

| | |
|--|---------|
| Active power loss total typical | 6 W |
| Surge voltage resistance Rated value | 6 000 V |
| Mechanical service life (switching cycles) | |
| • of the main contacts typical | 100 000 |
| Protection class IP | |
| • on the front | IP20 |
| Equipment marking | |
| • acc. to DIN EN 61346-2 | Q |

Main circuit:

| | |
|---|-------------|
| Number of poles for main current circuit | 3 |
| Adjustable response value current of the current-dependent overload release | 1.4 ... 2 A |
| Operating voltage | |
| • Rated value | 690 V |
| • at AC-3 Rated value maximum | 690 V |
| Operating current | |
| • at AC-3 | |
| — at 400 V Rated value | 2 A |
| Operating frequency | |
| • at AC-3 maximum | 15 1/h |

| Auxiliary circuit: | |
|--|--|
| Number of CO contacts | 0 |
| <ul style="list-style-type: none"> • for auxiliary contacts | |
| Product expansion Auxiliary switch | Yes |
| Protective and monitoring functions: | |
| Trip class | CLASS 10 |
| Maximum short-circuit current breaking capacity (I_{cu}) | |
| <ul style="list-style-type: none"> • with AC at 240 V Rated value • with AC at 400 V Rated value • with AC at 500 V Rated value • with AC at 690 V Rated value | 100 kA 100 kA 100 kA 8 kA |
| Short-circuit: | |
| Design of the overcurrent release and short-circuit release | thermomagnetic |
| Installation/ mounting/ dimensions: | |
| mounting position | any |
| Mounting type | screw and snap-on mounting onto 35 mm standard mounting rail according to DIN EN 50022 |
| Height | 97 mm |
| Width | 45 mm |
| Depth | 96 mm |
| Required spacing | |
| <ul style="list-style-type: none"> • with side-by-side mounting <ul style="list-style-type: none"> — Backwards — at the side | 0 mm 0 mm |
| Connections/ Terminals: | |
| Product function | No |
| <ul style="list-style-type: none"> • removable terminal for auxiliary and control circuit | |
| Type of electrical connection | |
| <ul style="list-style-type: none"> • for main current circuit • for auxiliary and control current circuit | screw-type terminals screw-type terminals |
| Arrangement of electrical connectors for main current circuit | front side |
| Type of connectable conductor cross-section | |
| <ul style="list-style-type: none"> • for main contacts <ul style="list-style-type: none"> — solid — stranded — finely stranded with core end processing • for AWG conductors for main contacts | 2x (1 ... 2.5 mm ²), 2x (2.5 ... 6 mm ²) 2x (1 ... 2.5 mm ²), 2x (2.5 ... 6 mm ²) 2x (1 ... 2.5 mm ²), 2x (2.5 ... 6 mm ²) 2x (14 ... 10) |
| Safety related data: | |

| | |
|-------------------------------------|-------------|
| Protection against electrical shock | finger-safe |
|-------------------------------------|-------------|

Mechanical data:

| | |
|-----------------------------|----|
| Size of the circuit-breaker | S0 |
|-----------------------------|----|





Ambient conditions:



| | |
|---|---------|
| Installation altitude at height above sea level maximum | 2 000 m |
|---|---------|

| | |
|---------------------|----------------|
| Ambient temperature | |
| • during operation | -20 ... +60 °C |
| • during storage | -50 ... +80 °C |
| • during transport | -50 ... +80 °C |

Certificates/ approvals:

| General Product Approval | For use in hazardous locations | Declaration of Conformity |
|--|---|---|
|  CCC |  EAC |  EG-Konf. |
|  CSA |  ATEX | |
|  UL | | |

| Test Certificates | Shipping Approval |
|--|---|
| Special Test Certificate |  ABS |
| |  BUREAU VERITAS |
| |  DNV |
| |  GL |
| |  LRS |

| Shipping Approval | other |
|---|--|
|  RMRS | Declaration of Conformity |
| | Environmental Confirmations |
| | Confirmation |
| |  VDE |
| | other |

Further information

- Information- and Downloadcenter (Catalogs, Brochures,...)
<http://www.siemens.com/industrial-controls/catalogs>
- Industry Mall (Online ordering system)
<http://www.siemens.com/industrymall>
- Cax online generator
<http://support.automation.siemens.com/WW/CAXorder/default.aspx?lang=en&mlfb=3RV10211BA10>
- Service&Support (Manuals, Certificates, Characteristics, FAQs,...)
<https://support.industry.siemens.com/cs/ww/en/ps/3RV10211BA10>
- Image database (product images, 2D dimension drawings, 3D models, device circuit diagrams, EPLAN macros, ...)
http://www.automation.siemens.com/bilddb/cax_de.aspx?mlfb=3RV10211BA10&lang=en

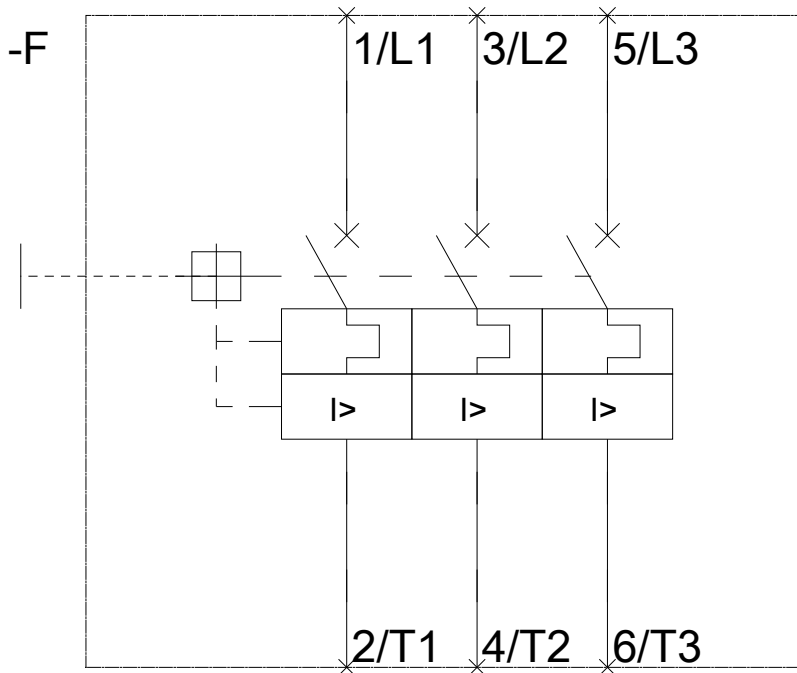
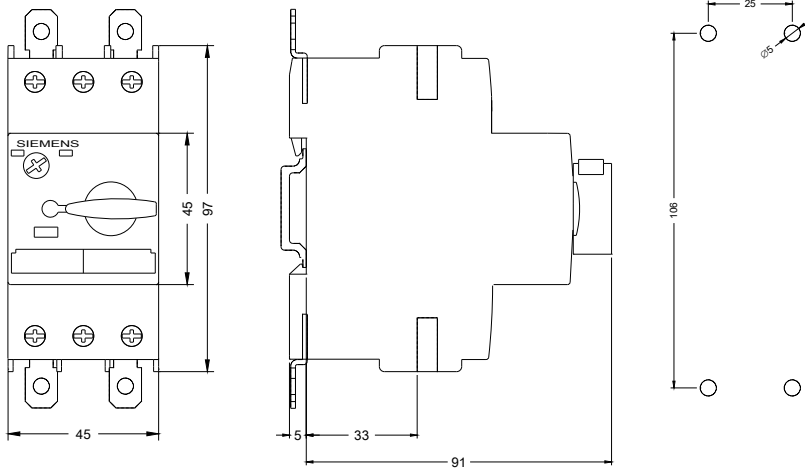

last modified:

27.04.2015